

Weight: 3 Kg
 Power supply: 350 mA
 Input: 220/240 V
 Output: 24 V
 Power consumption: 3 W
 Color temperature: 2700K

CE **F** **CLIII IP68**

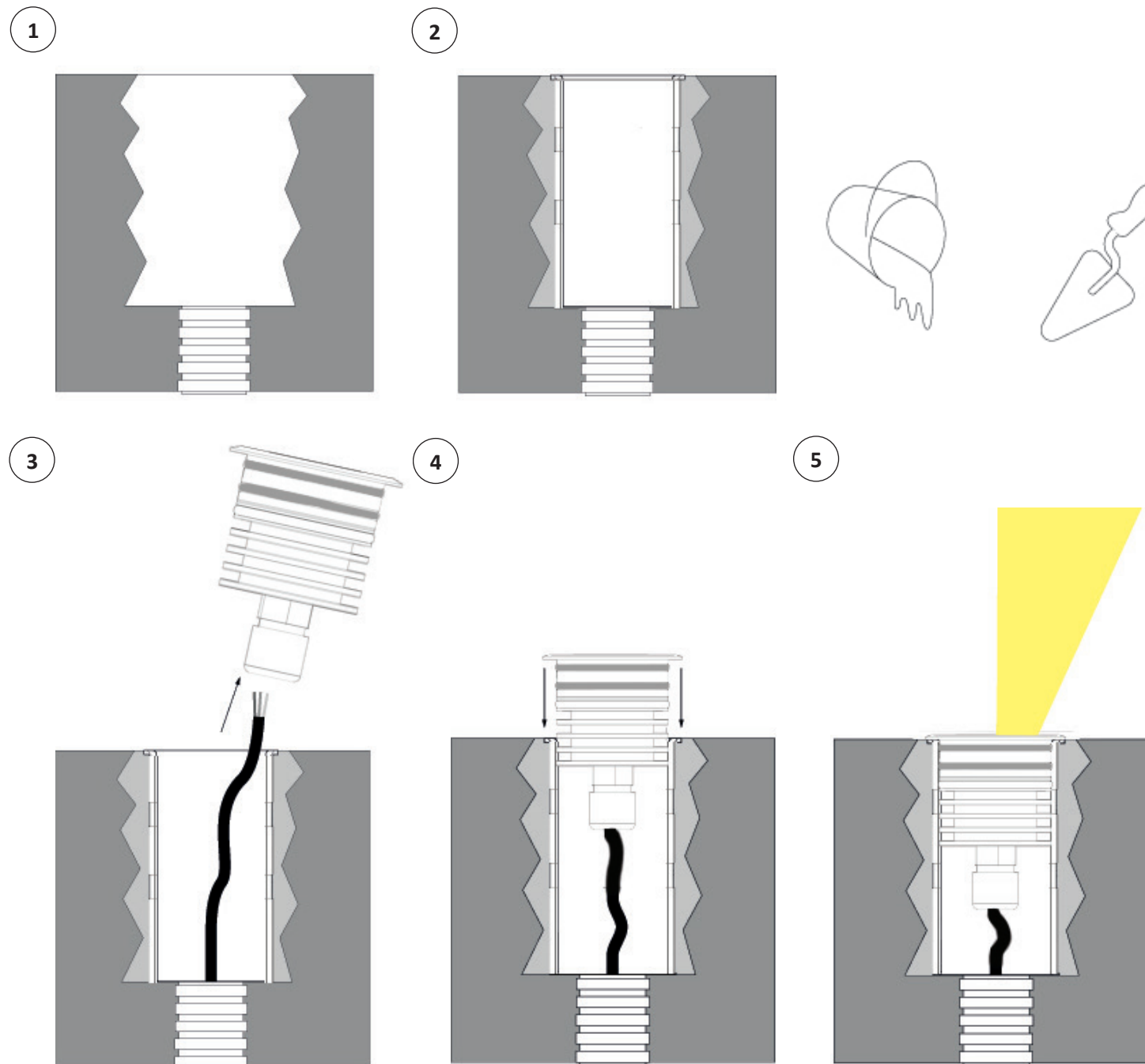

N.B. Before working on the fixture, ensure that the main switch is disengaged.

Proceed as follows to wire and assemble the luminaire:

- 1 - Place the casing on the ground;
- 2 - Cementing the casing inserted;
- 3 - To pass the electric cables into the casing;
- 4-5 - Insert the luminaire into the casing;