

ANGEL MINI BOLLARD

URBAN
LIGHTING

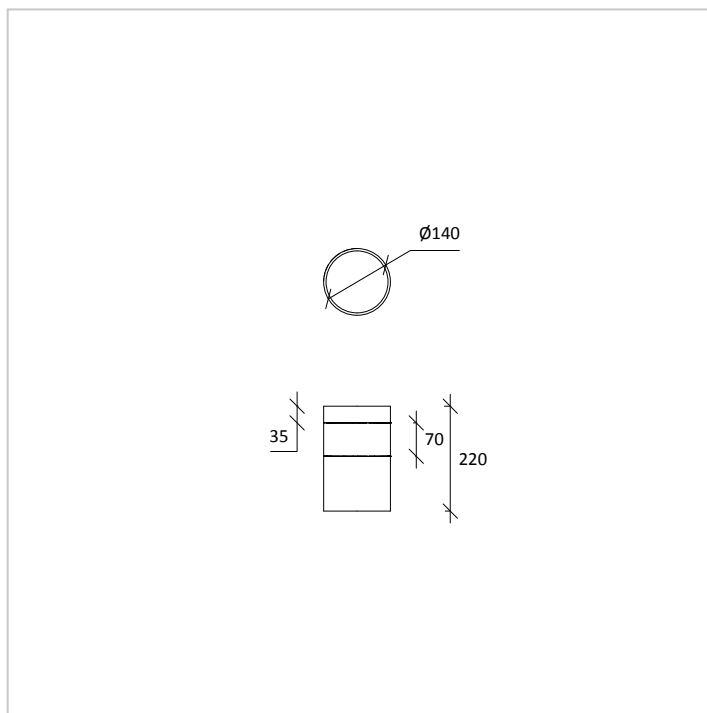

Angel Mini Bollard is a residential and parks decorative lighting fixture, functional pole for walkways.



CE   CLI IP 65

PRODUCT DESCRIPTION

Body and base plate: made of stainless steel AISI316L, with double stratification and certified marine grade protection on request.

Diffuser: made in opal PMMA anti-crash.

Screws: made of stainless steel AISI 304

Fixing system pole: with plate and anchor bolts.

Wiring: cable connection in the rear compartment through a door, cable input from bottom. Fast plug in. Power supply integrated in the rear compartment.

Dimming options: Standard Switch ON/OFF and dimmable 1-10.

PHOTOMETRY

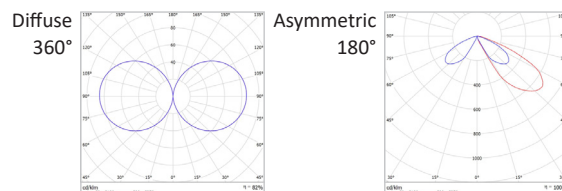

TECHNICAL DATA

| | |
|--------------------|--------------------------------|
| Colour temperature | 3000 K - 4000 K - 5000 K - RGB |
| Luminous flux | 1100 lm - 550 lm * |
| Power supply | 18 W - 9 W |
| Luminous efficacy | ~ 61 lm/W * |
| Colour index | 90 CRI * |
| Optics | Diffuse 360° - Asymmetric 180° |
| Driving current | 700 mA |
| Input | 220 - 240 V 50-60 Hz |

* Values are referred to 4000K

Tassoni & Pesenti

Head Office

address - Via Montegrappa, 32, 20080 Albairate (MI) Italy

web site - www.tplight.it

mail - info@tplight.it

tel/fax - +39.02.97162704

Registered Office

address - Viale E. Forlanini, 23, 20134 Milano (MI) Italy

C.F. & P.I. 07703840962

N° REA 1976624

